

**NOTICE OF WATER SERVICE SHUTDOWN**  
**AFFECTING PROPERTIES ON BLACKHORSE DRIVE & SORREL LANE**  
**ON WEDNESDAY, APRIL 24, 2024, FROM 9:00 A.M. TO 6:00 P.M.**

Due to a planned system maintenance shutdown, water service will be temporarily disrupted as indicated above. Also, there may be fluctuating pressure and/or air in the water for a short period thereafter.

You should expect water service interruption to occur during the entire time as indicated above. Please plan accordingly by making private arrangements for adequate water if you cannot be without water during this time. You may want to consider storing water in a bathtub for toilet flushing during this time.

If your home or business has a fire alarm system that automatically alerts your alarm monitoring company when the water pressure drops, you will need to notify them, prior to the scheduled shutdown time, to prevent any false alarms being sent to the Fire Department.

We appreciate your understanding and apologize for any inconvenience caused. We will strive to restore normal service as quickly as possible.

*Brian Vigil*

Brian Vigil  
Field Maintenance Superintendent – Preventative Maintenance  
951-674-3146 x 8218

---

*Our Mission...*

The EVMWD team delivers total water management that powers the health and vibrancy of its communities so life can flourish.

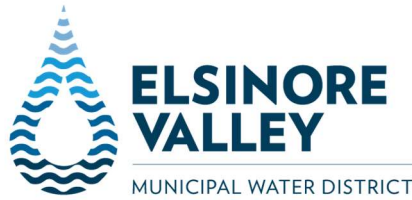

## **AVISO DE INTERRUPCION DE SERVICIO DE AGUA**

### **BLACKHORSE DRIVE AND SORREL LANE**

**FECHA DE  
INTERRUPCION:** HORAS ENTRE MIÉRCOLES, ABRIL 24, 2024, 9:00 A.M. – 6:00 P.M.

**TEMA:** Interrupción o baja presión en servicio de agua

Debido a un cierre planificado por mantenimiento del sistema, el servicio de agua se verá temporalmente interrumpido según lo indicado anteriormente. Además, puede haber fluctuaciones de presión y/o aire en el agua durante un breve período después de la interrupción.

Es importante que tenga en cuenta que la interrupción del servicio de agua ocurrirá durante todo el tiempo indicado arriba. Le pedimos que se prepare haciendo arreglos privados para contar con suficiente agua si no puede prescindir de ella durante este período. Puede considerar almacenar agua en una bañera para usar en el inodoro durante este tiempo.

Si su hogar o negocio cuenta con un sistema de alarma contra incendios que alerta automáticamente a su empresa de monitoreo de alarmas cuando la presión del agua disminuye, deberá notificarles antes del horario programado de cierre para evitar que se envíen falsas alarmas al Departamento de Bomberos.

Agradecemos su comprensión y nos disculpamos por cualquier inconveniente que esto pueda causar. No esforzaremos por restaurar el servicio normal lo más rápido posible.

*Brian Vigil*

Brian Vigil  
Field Maintenance Superintendent – Preventative Maintenance  
951-674-3146 x 8218

---

*Our Mission...*

The EVMWD team delivers total water management that powers the health and vibrancy of its communities so life can flourish.

# Canyon Lake Sustaining Station Shutdown

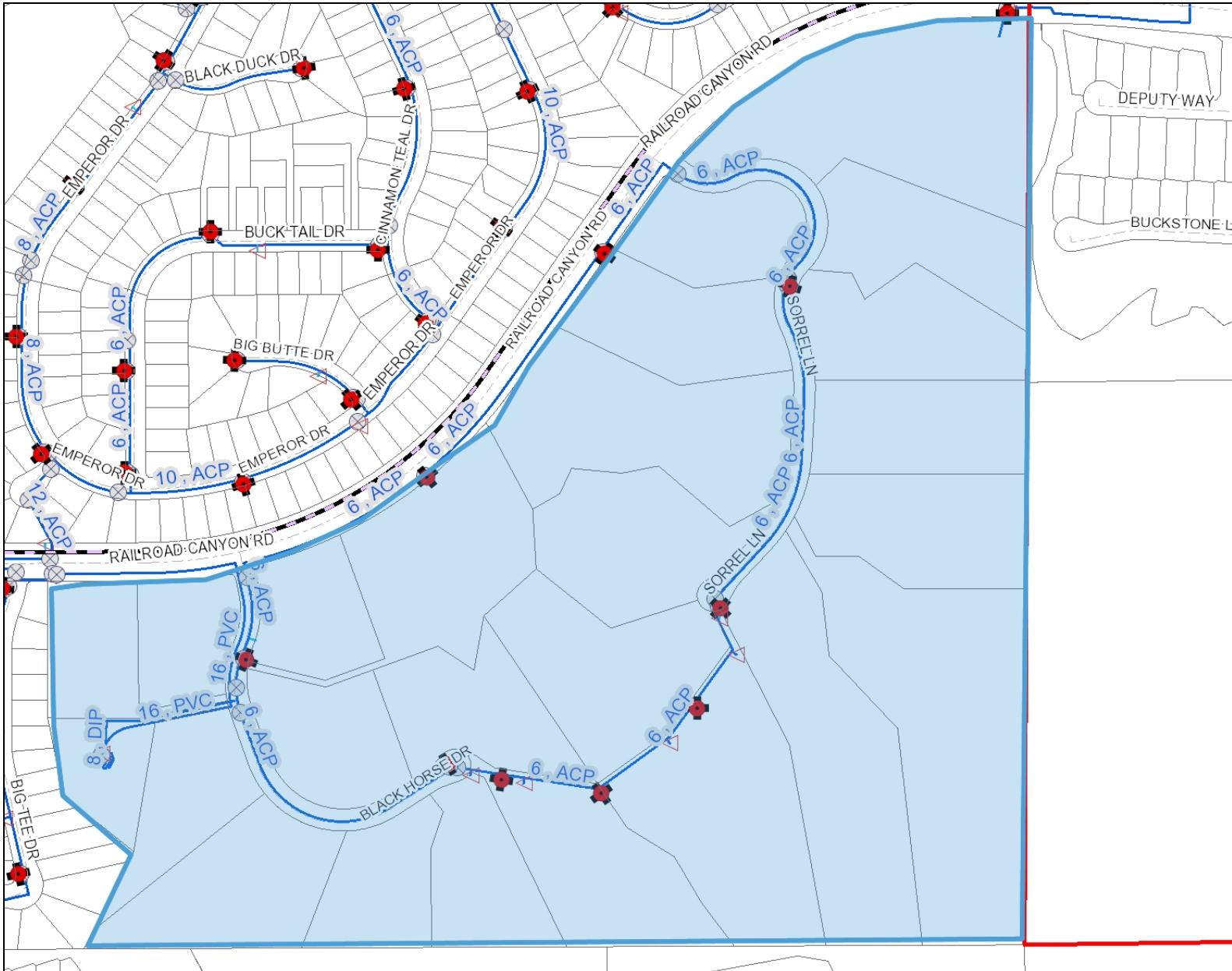

## Legend

- EMWD Recycled Water Lines
- Inactive Pressure Main
- EVMWD Boundary
- Highways
- Street Centerlines
- Parcels
- Waterbodies
- Ag Line**
  - Ag Line
  - Open Canal
  - Siphon
- Recycled Meters
- Air Release Valve
- Fire Hydrants**
  - Commercial
  - Residential
- Label Diameter**
- Valves**
  - Butterfly Valve
  - Gate Valve
- Pressure Main**
  - Distribution Main
  - Transmission Main
  - Air Release
  - Blowoff
  - Hydrant Lateral
  - Unknown

1: 5,000



833.3      0      416.67      833.3 Feet

This application has been provided to give a visual display of District facilities and related geographic information. To be sure of complete accuracy, please check with Engineering staff for the most up to date information.

## Notes